

Pipes & fittings

Pipes

SROR – Downpipe



Size mm	Di mm	d mm
75	75	73
87	87	85
100	100	98
120	120	118

- Roll formed 0.6mm steel with solid seam (0.7mm for 120mm pipes)
- Hidden male/female joint, sockets are not required
- Supplied in 3m lengths as standard
- Also available in 2.5m or 1m shorter lengths

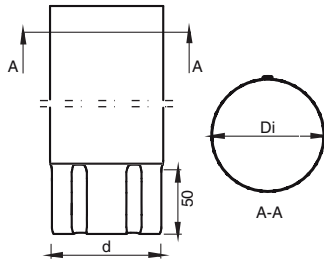

MSTRA – Rod Access Pipe



- Used to provide access for maintenance rod to remove pipe blockages
- Supplied in 1m length with double spigot male ends
- Second spigot can be removed if not required
- Steel door can be unlocked and removed using plastics handles

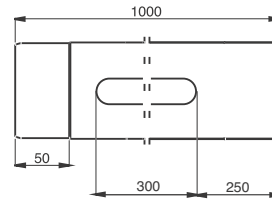

01

MST – Intermediate Pipe 1m / 0.5m



- Typically used to make an offset with >100mm projection
- 1m length option supplied with double spigot male ends
- Can be cut to make two short pipes
- 0.5m supplied with male/female ends

1m

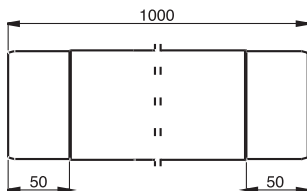

0.5m

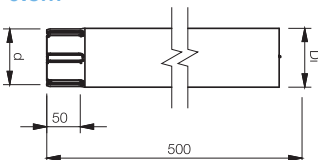

Size mm	Di mm	d mm
75	75	73
87	87	85

PRT – Sliding Pipe



Size mm	D mm
75	77
87	89
100	102

- Used with an RT Drain Trap
- Provides easy access for cleaning
- Fits outside the down pipe

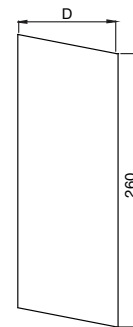

Pipe brackets

Used for fixing pipes to the wall

- Recommended maximum 1.5m interval spacing

SSVU – Universal Pipe Bracket



Size mm	D mm
75	77
87	89
100	102
120	122

- Can be used to screw fix pipes to the wall or used with SST Spike for drive-in fixing
- Easy click function secures pipe in place
- Required 2 screws or spike for fixing

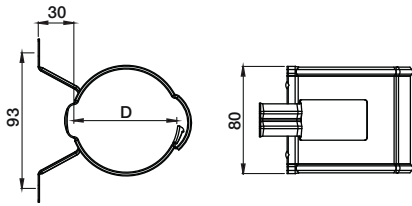

SVHA – Down Pipe Bracket



Size mm	D mm
75	77
87	89
100	102
120	122

- Required for unpainted systems
- Used to screw fix pipes to the wall
- Wedge is used to secure pipe into place
- Requires 2 screws for fixing

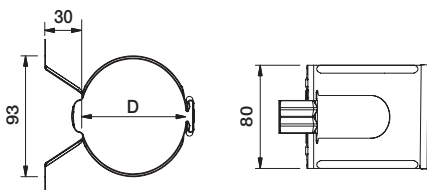

SV – Pipe Holder (for Spike)



Size mm	D mm
75	77
87	89
100	102
120	122

- Required for unpainted systems
- Used to attach pipe to spike fixed into the wall
- Wedge is used to secure pipe into place
- When pipe holder is closed the spike locks in place
- Spike is ordered separately

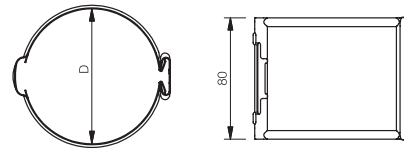

SST – Spike (for Pipe Holder)



Size mm	L mm
125	125
175	175
250	250
300	300

- Used with pipe holder to fix pipe to the wall
- Spike is ordered separately, supplied in plain galvanised finish only
- Available in 125mm, 175mm, 250mm and 300mm lengths
- When pipe holder is closed the spike locks in place

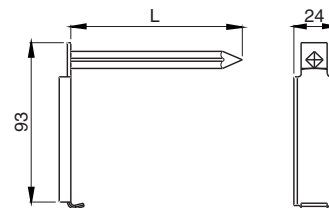

Pipes & fittings

Hoppers

Used with outlet spouts or to maximise pipe flow rate

VATKR – Regular Water Hopper



- Used at the head of a pipe that doesn't directly connect to a gutter
- Rectangular front with square sides
- 250 x 150 x 150mm

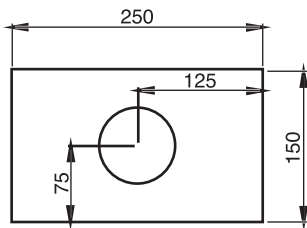

VATKL – Large Water Hopper



- Used with high flow outlet spouts or where multiple gutters meet
- Square top with inverted pyramid sides

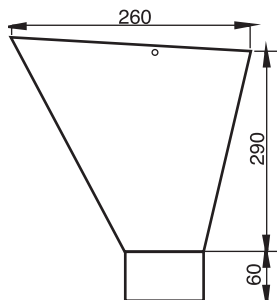

Bends

Used for offsetting pipe stacks and traversing facade features

BK – Conical pipe bend



Size mm	Di mm	d mm
75	75	73
87	87	85
100	100	98
120	120	118

- Conical shape provides clean line while allowing male/female connection
- Top is perfect fit for outlets or male spigot ends of pipes
- Bottom fits directly into standard pipe
- Available in 45°, 70° and 85° variations

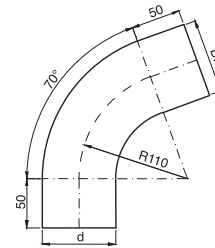

BM – Pipe bend with socket



Size mm	Di mm	d mm
75	77	75
87	89	87
100	102	100
120	122	120

- Traditional socket allows male/female connection
- Top will fit directly to a cut end of a standard pipe
- Bottom fits directly into standard pipe
- Available in 45°, 70° and 85° variations

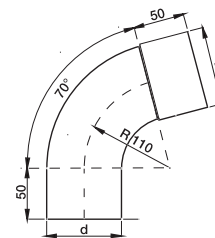

SOKN – One-Piece Offset



Size mm	D mm	d mm
75	77	75
87	89	87
100	102	100
120	122	120

- Used to offset a pipe stack usually to join to a gutter outlet or to traverse a plinth
- Set 100mm projection
- Longer offsets can be assembled using bends and cut down pipes

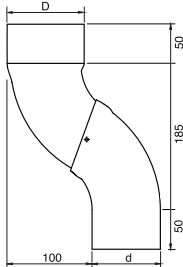

BUTK – Drain Shoe



Size mm	D1 mm	D2 mm
75	81	115
87	93	115
100	93	115
111	93	119
120	93	119

- Used to connect a pipe directly to a ground drain pipe
- Fits outside the down pipe
- Cover sits over drain pipe
- Can be lifted to provide maintenance access

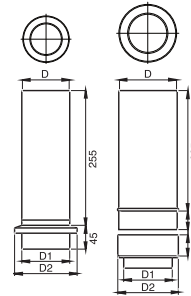

Shoes

Used at the bottom of a pipe stack

UTK – Pipe Shoe



Size mm	Di mm	d mm
75	110	151
87	110	157
100	110	113
120	110	173

- Angled pipe shoe used to discharge water into a drain or grate
- Socket fits directly to pipe
- Rolled rim ensures no sharp edges

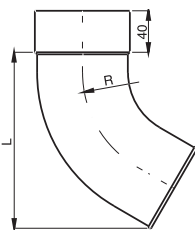

RT – Drain Trap (HD Polythene)



- Used to prevent leaves and other blockages entering the drain
- Connects to 100mm drain pipe
- Should be used with PRT sliding pipe to allow cleaning

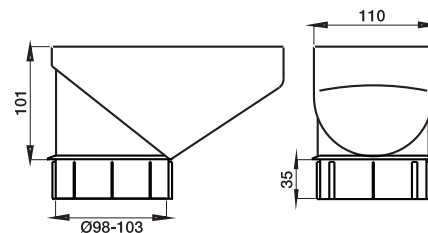

Pipes & fittings

SLS – Self Cleaning Leaf Trap (HD Polythene)



- Used to filter leaves and other blockages from the drain pipe
- Angled design allows rainwater to clean the filter
- Connects to 100mm drain pipe
- Can be used with a BUTK Drain Shoe to fit 75mm or 87mm pipes

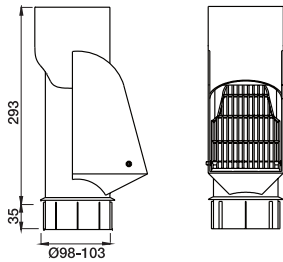

SRORM – Pipe Connector



Size mm	D mm	d mm
75	77	73
87	89	85
100	102	98
120	122	118

- Used to connect two pipes if the male spigot has been removed
- Allows pipe offcuts to be used
- Provides male/female connection

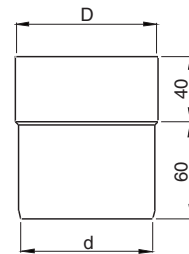

05

Connectors

GROR – Branch



- Used to merge a second pipe run into a pipe stack
- Branch can be positioned between 50° and 80°
- Standard branch will connect equal pipe diameters
- Unequal branches are available which will fit pipes with smaller diameters

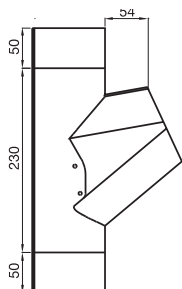

MRT – Drain Connector (HD Polythene)



- Used to directly connect to a ground drain pipe
- Stepped design fits to multiple sizes
- Fits up to 100mm down pipes and drain pipes

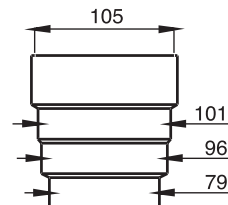

SLAS – Hose Connector



- Used to connect pipe directly to a hose
- Only available in 87mm
- Fits to 80mm hose

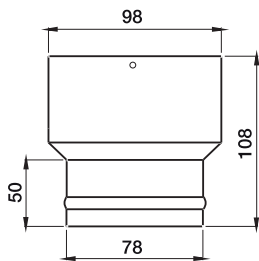

Diverters

Used to collect water in a water butt

FUTK – Adjustable Diverter



- Outlet spout manually opens and closes
- Spout attached with stainless steel rivets
- Fits directly to pipe stack

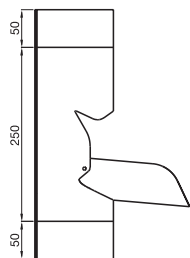

RWDC – Rainwater Diverter Kit (HD Polythene)



- Plastic components divert water through flexible hose
- 2 screw holes for wall fixing
- Fits to 75mm or 87mm pipe stacks