



Beauty that lasts – painted Rainline

A choice of 10 painted colours to suit classic or contemporary aesthetics for domestic or commercial properties. High-build, scratch-resistant polyester paint is UV stable, has excellent colour fastness and is flexible which ensures that the coating isn't damaged when products are formed from the sheet steel. Painted Rainline systems are supplied with a 15 year warranty.

Colours displayed may vary from actual, NCS and RAL codes are the nearest colour match. Swatch samples can be supplied to demonstrate true colour.



Silver Metallic
RAL 9006

Anthracite Grey
RAL 7016
NCS S 7502-B

Black
RAL 9011
NCS S 9000-N

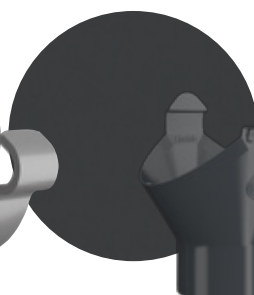
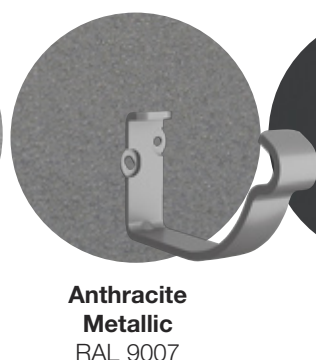



Antique White
RAL 9002
NCS S 1002-G50Y

Coffee Brown
RAL 8019
NCS S 8502-Y

Dark Red
RAL 3009
NCS S 5040-Y80R

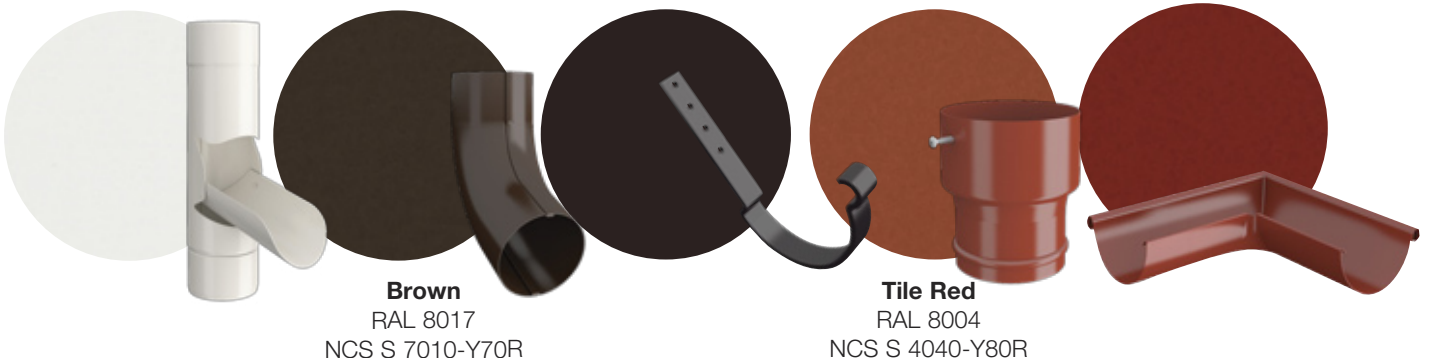



An elegant finish – unpainted metals

Unpainted metal options provide a uniquely attractive organic aesthetic. The new improved Magestic galvanised rainwater system and supreme natural copper Rainline system will weather and adjust to the environment requiring minimum maintenance.

Unpainted finishes are not covered by Lindab's 15 year warranty. Lindab Magestic carries a 10 year warranty. For further details of Lindab warranties see www.lindab.co.uk

Magestic

Magestic – The King of Galvanised Gutters, an improved galvanised steel with a strengthened magnesium zinc alloy coating offering the highest surface protection of any metallic coated steel. Magestic settles into an attractive dark grey metallic appearance within 3-5 years after installation.

Natural Copper

A limited range of Rainline products are available in uncoated copper. The finish is highly desirable and provides excellent corrosion resistance once it has transitioned to a greenish verdigris patina.

Stainless Steel

Only Rainline Vandal proof products are available in a stainless steel finish. The products are made from 1.5m stainless steel plate.

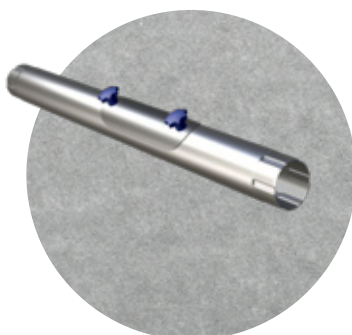

Magestic Galvanised



Natural Copper



Stainless Steel